

Technical details - Curved Door Model W2F (2 doors - 1 sliding, 1 fixed)

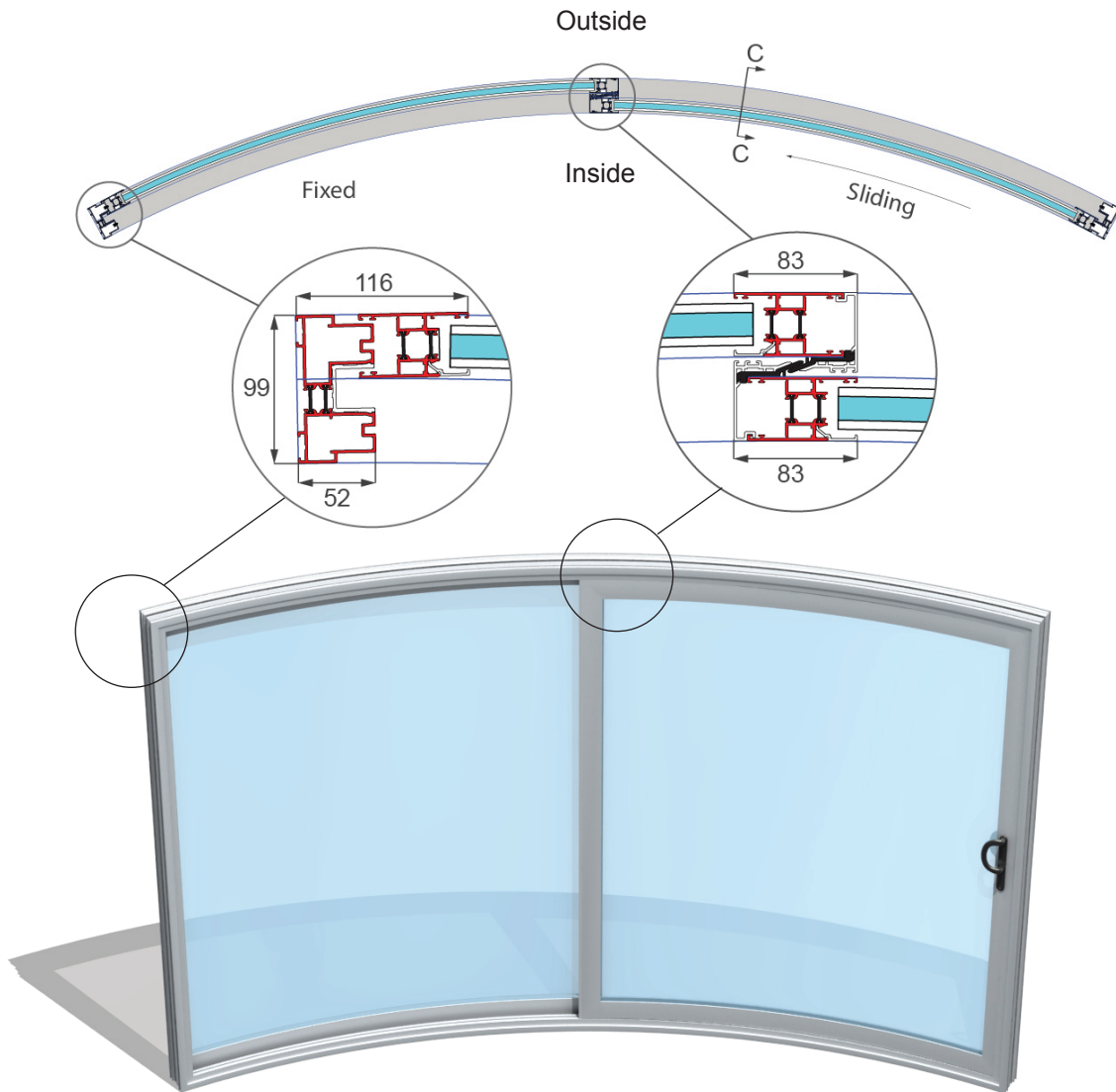

W2F Generic Section C-C

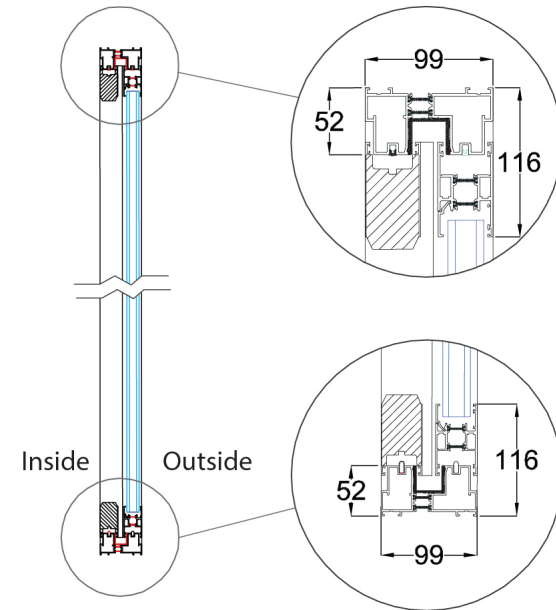

Section Profile Structure

Twin Polyamide Thermally Broken 6063 T5 extruded aluminium profiles, stainless steel wheel track

Paint/coating: 60-100 micron

Polyester powder coating in standard RAL colour, dual colour options available

Glazing

28 mm Toughened Low-E Double glazing in three options of centre pane U value; 1.7 W/m²K, 1.5 W/m²K or 1.0 W/m²K

Gaskets

EPDM(ethylene-propylene rubber) in black

Recommended Max Height

2600mm

Recommended Max length

3500mm (1750mm per sash)

Sliding Mechanism

Regular sliding, bottom rollers

Free instant quotes
www.balconette.co.uk



Technical details - Curved Door Model W3F (3 doors - 2 sliding, 1 fixed)

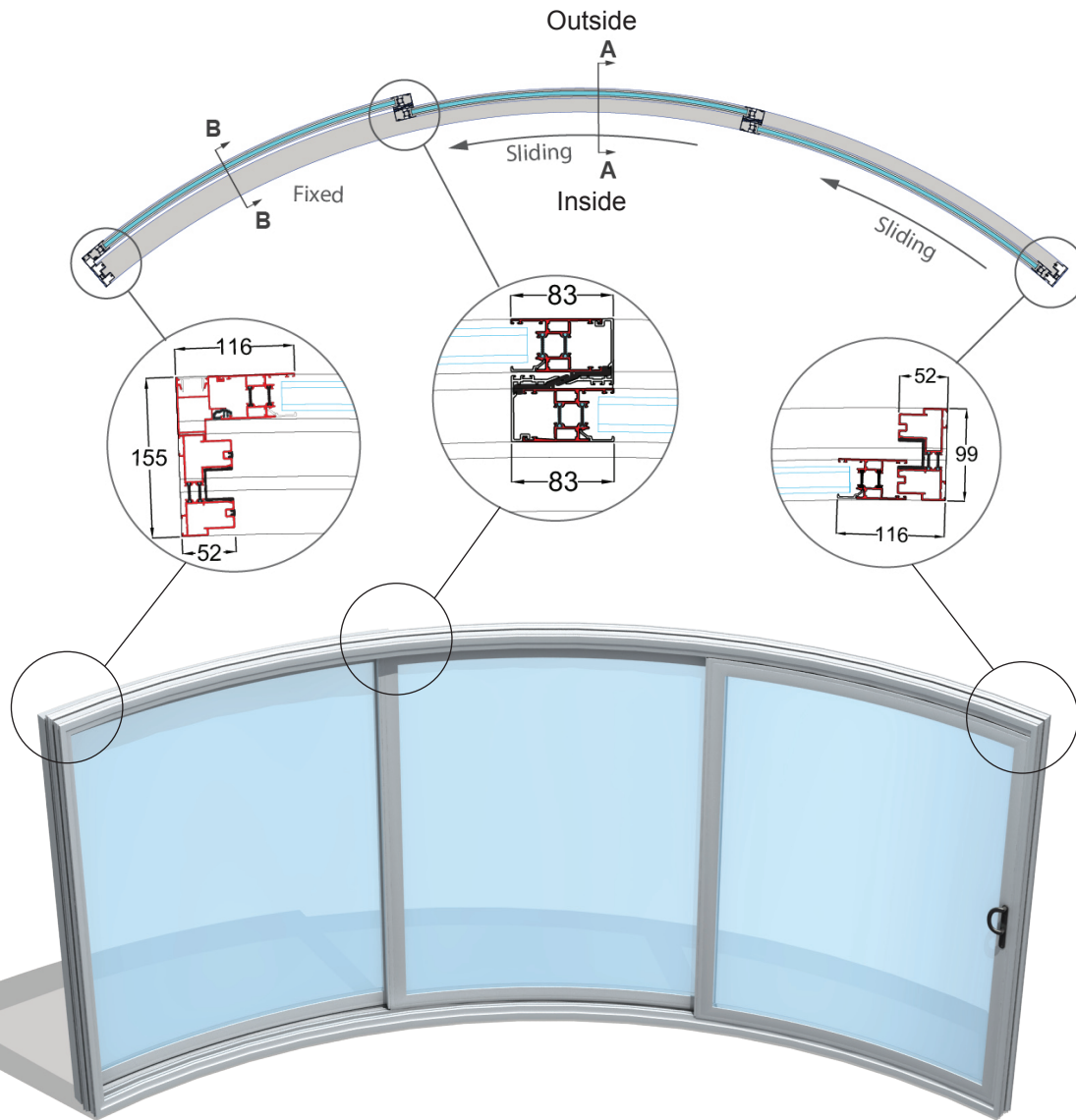

W3F Generic Section B-B

W3F Generic Section A-A

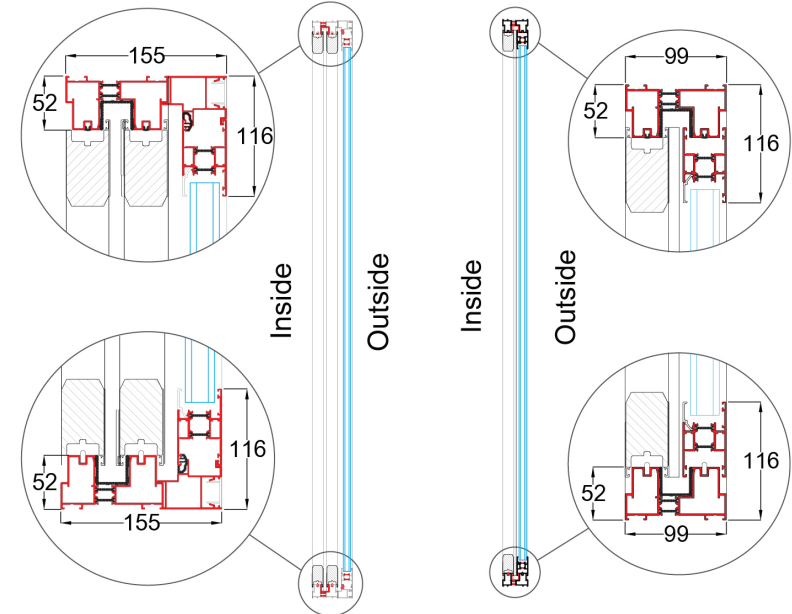

Section Profile Structure

Twin Polyamide Thermally Broken 6063 T5 extruded aluminium profiles, stainless steel wheel track

Paint/coating: 60-100 micron

Polyester powder coating in standard RAL colour, dual colour options available

Glazing

28 mm Toughened Low-E Double glazing in three options of centre pane U value; 1.7 W/m²K, 1.5 W/m²K or 1.0 W/m²K

Gaskets

EPDM (ethylene-propylene rubber) in black

Recommended Max Height 2600mm

Recommended Max length 5250mm (1750mm per sash)

Sliding Mechanism Regular sliding, bottom rollers

Free instant quotes
www.balconette.co.uk



Technical details - Curved Door Model W4F (4 doors - 2 sliding, 2 fixed)

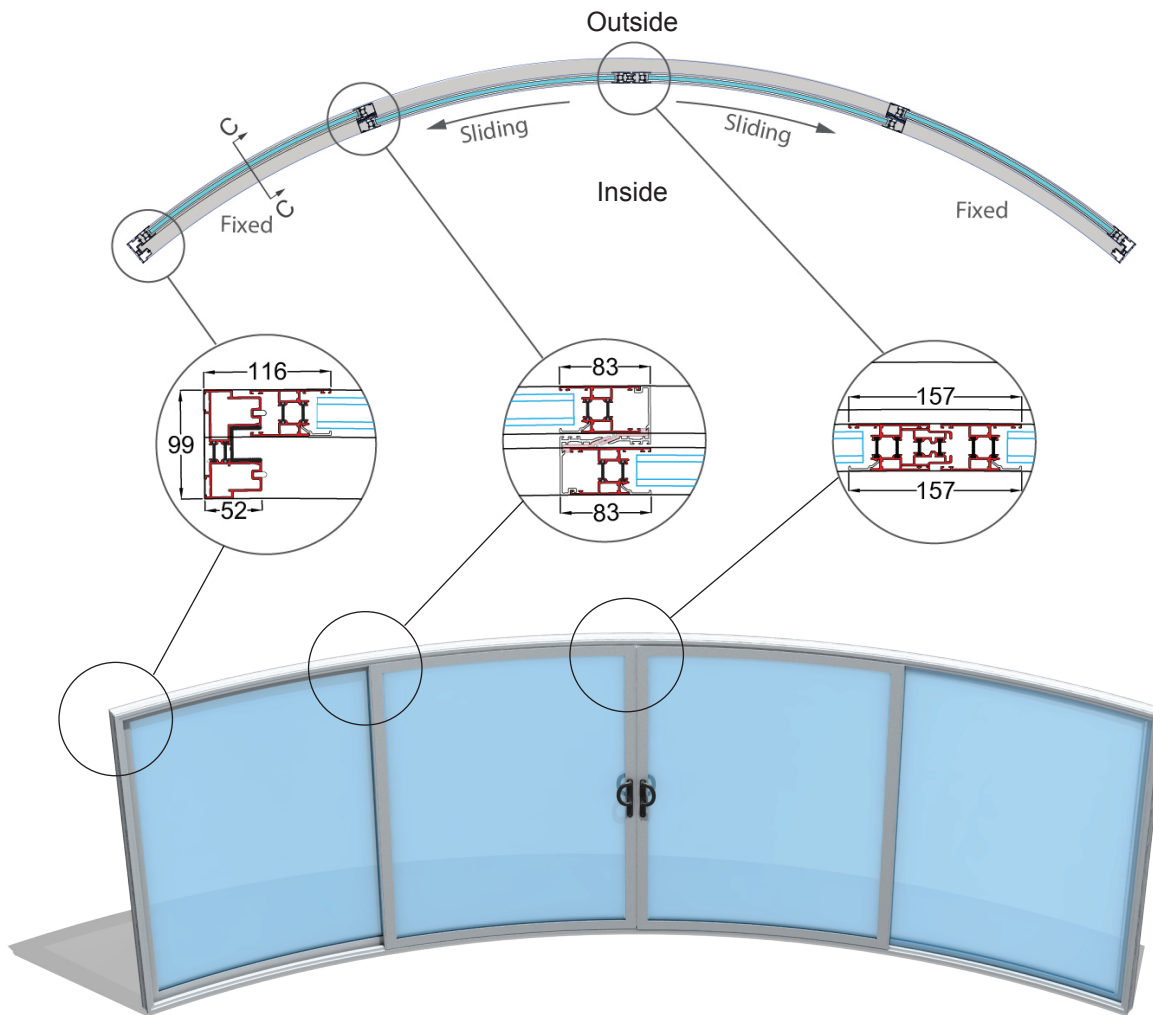

W4F Generic Section C-C

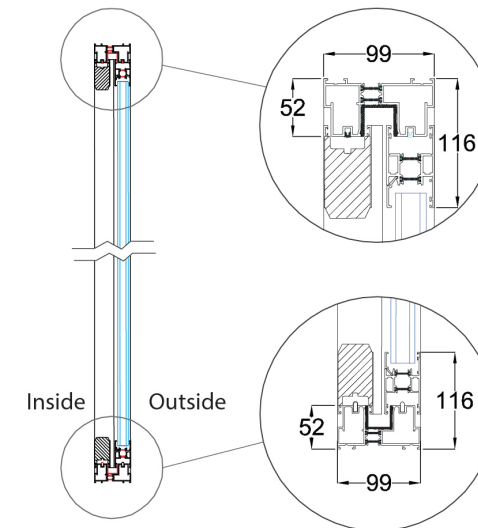

Section Profile Structure

Twin Polyamide Thermally Broken 6063 T5 extruded aluminium profiles, stainless steel wheel track

Paint/coating: 60-100 micron

Polyester powder coating in standard RAL colour, dual colour options available

Glazing

28 mm Toughened Low-E Double glazing in three options of centre pane U value; 1.7 W/m²K, 1.5 W/m²K or 1.0 W/m²K

Gaskets

EPDM (ethylene-propylene rubber) in black

Recommended Max Height 2600mm

Recommended Max length 7000mm (1750mm per sash)

Sliding Mechanism Regular sliding, bottom rollers

Free instant quotes
www.balconette.co.uk



Technical details - Curved Door Model W6F (6 doors - 4 sliding, 2 fixed)

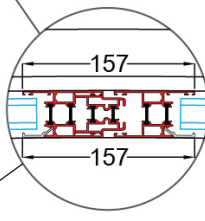
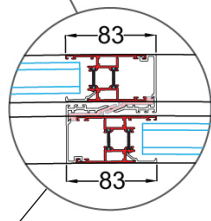
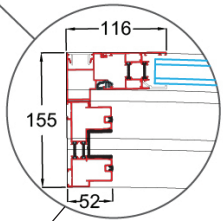
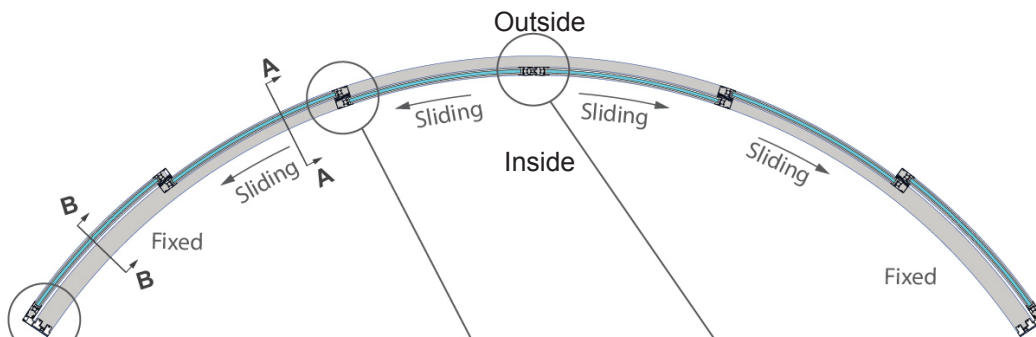

W6F Generic Section B-B

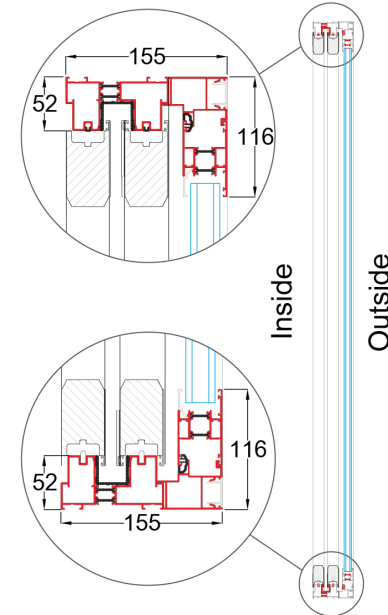

W6F Generic Section A-A

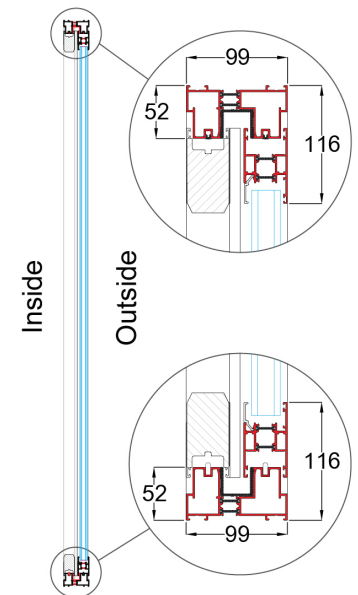

Section Profile Structure

Twin Polyamide Thermally Broken 6063 T5 extruded aluminium profiles, stainless steel wheel track

Paint/coating: 60-100 micron

Polyester powder coating in standard RAL colour, dual colour options available

Glazing

28 mm Toughened Low-E Double glazing in three options of centre pane U value; 1.7 W/m²K, 1.5 W/m²K or 1.0 W/m²K

Gaskets

EPDM (ethylene-propylene rubber) in black

Recommended Max Height

2600mm

Recommended Max length

10500mm (1750mm per sash)

Sliding Mechanism

Regular sliding, bottom rollers

Free instant quotes
www.balconette.co.uk

