

# Technical details - Curved Door Model W2F (2 doors - 1 sliding, 1 fixed)

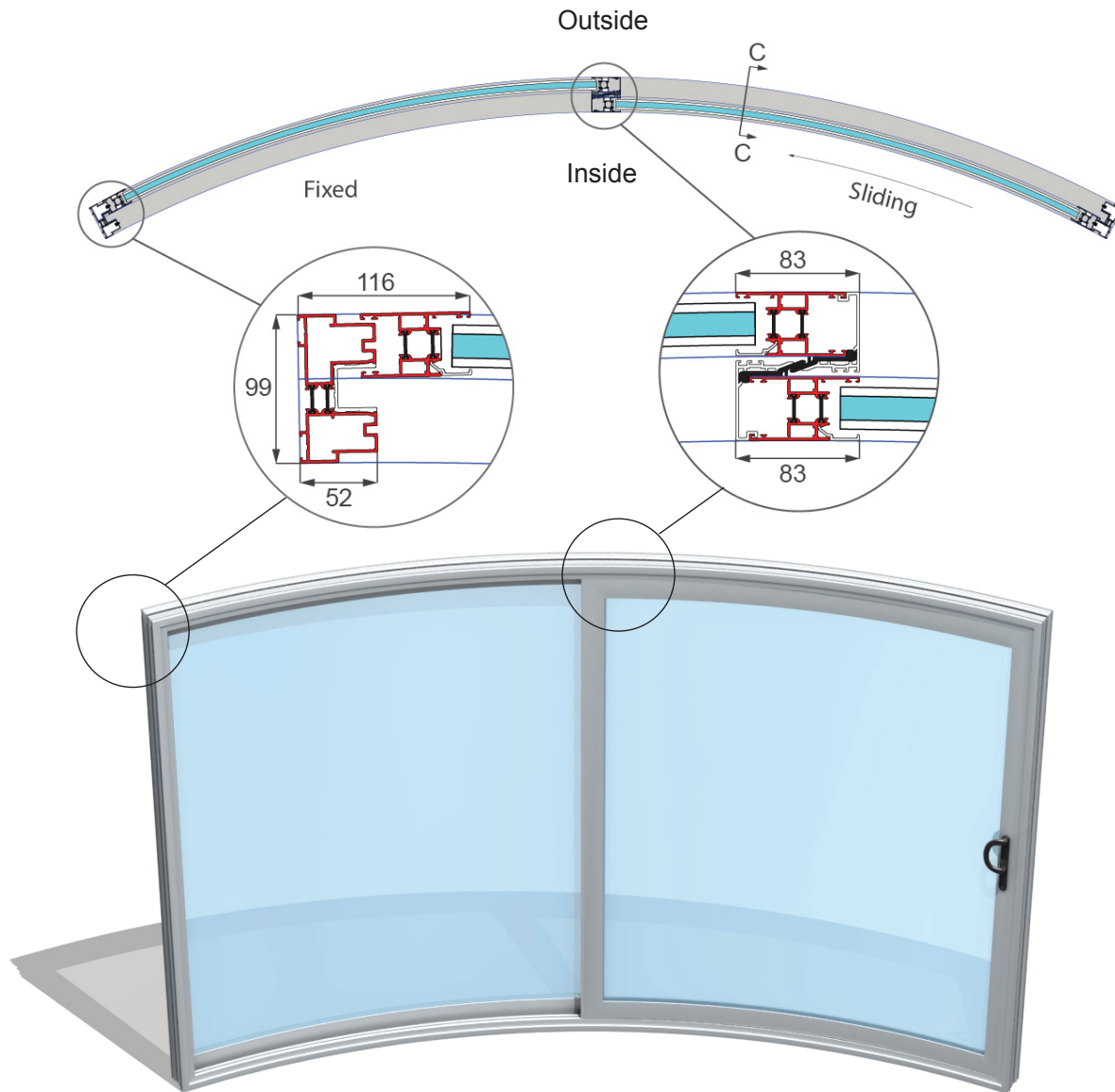

## W2F Generic Section C-C

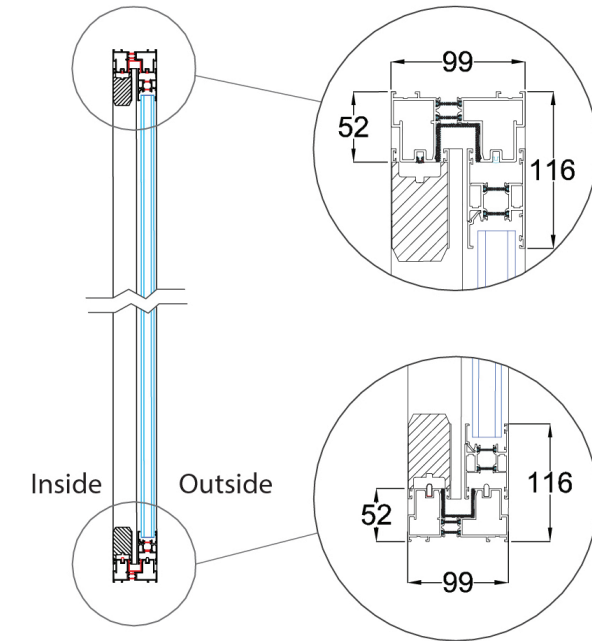

### Section profile structure

Thermally Broken 6063 T5 extruded aluminium profiles, stainless steel wheel track

### Paint/coating: 60-100 micron

Polyester powder coating in standard RAL colour, dual colour options available

### Glazing

28 mm high performance "soft coat" Low-E double glazing with centre pane U value 1.0 W/m<sup>2</sup>K. Toughened safety glass on both sides. Optional BalcoNano® self-cleaning coating

### Gaskets

EPDM(ethylene-propylene rubber) in black

Recommended max height 2600mm

Recommended max length 3500mm

Sliding mechanism

Regular sliding, bottom rollers

**Curvaglide**® By

**Balconette**